

IN00240 (rev B)

Wetroom Floor

Before You Start

- Visit www.wickes.co.uk and view the DVD demonstration of how to install a wetroom floor.
- Read the manufacturers instructions for installation of under floor heating before you proceed.
- When installing on a suspended floor, ensure it is strong enough to carry the extra weight of the tiles, that it is very rigid and the area below the floorboards is well ventilated. Any movement may cause the grout to break allowing moisture to ingress and tiles to lift.
- The floor level will inevitably be raised so the bathroom door will need to be adjusted to accommodate the extra height of the tiles and new floor.
- There is an inherent risk of slipping on a wet tiled surface, use wetrooms with care.

Safety

- Use safety eyewear when drilling.
- When drilling walls check first for hidden pipes and cables.
- Keep all small parts away from children.
- Handle unframed glass panels with care - support on cardboard to avoid risk of breakage.

Disclaimer

- Please notify the retailer immediately of any damage or faults. The Manufacturer cannot be held responsible for any installation costs that may arise from damaged or faulty product being installed.
- Please dispose of all packaging with due regard to the environment.



Toolbox

These are some of the tools you will require during the installation.



Check List

- Do not compromise on the waste. Wickes two part waste is specifically designed for the project.
- The Wickes Deck must be perfectly level, ensure you are capable of adjusting your floor where necessary.
- Mark the gradient lines, of the deck on cardboard before you start. Refer to tile template.
- Only use single part, flexible, cementitious tile adhesive. Do not use ready mix tile adhesive.
- Check your shower system is below 22 litres/ min.
- Leave enough time for each layer of tile adhesive to dry before proceeding to next section.
- Plan laying the fleece, ensure that you can leave the bathroom without stepping on the fleece.
- If you must step on the fleece, use long planks of wood to spread your weight.
- A 4mm trowel is recommended. If you can only source a 6mm trowel, angle the trowel closer to the floor to reduce the coverage.
- The remaining floor in the bathroom should be perfectly flat or, at best, angled towards the Wickes Deck. A 2mm drop is recommended.
- It is recommended that the shower head is positioned so that the user does not stand on the waste to ensure effective drainage.



0870 241 6131

LINES OPEN: 8.30am - 5.00pm MONDAY - FRIDAY
STANDARD NATIONAL CALL CHARGE RATE
FROM BT LANDLINES



Product Check List for a 5m² Bathroom

- 1 x Wickes Wetroom Deck (208287)
- 1 x Wickes Two Part Waste (208485)
- 1 x 5m² Pack of Wickes Fleece (207303)
- 3 x 5m pack of Wickes Jointing Tape (207306)
- External Corner as necessary (207305)
- Internal Corner as necessary - normally 2 packs (207304)



Please notify the retailer immediately of any damage or faults. The manufacturer cannot be held responsible for any installation costs that may arise from a damaged or faulty product being installed.



Keep small parts away from children

Wickes Wetroom Deck



The Preformed 1 in 40mm gradient will allow water to flow to the waste. It has been specially designed to take the guess work out of forming gradients.

Wickes Two Part Waste



- Two part waste allowing installation from above the deck.
- Horizontal ball joint that allows the gully to align to the aperture of the deck exactly.
- 50 to 40mm reducer to link up with standard waste outlets.
- Adjustable tile grate that allows for tile depths from between 6 and 26mm.
- Fleece clamping ring that secures the wetroom tanking kit.

5m² pack of Wickes fleece

Wickes External Corners inc.2 (per pack)

5m pack of Wickes Jointing Tape

Wickes Internal Corners inc.2 (per pack)

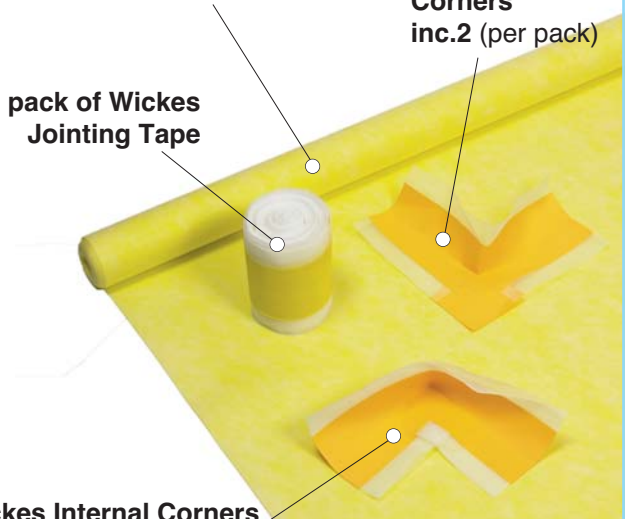

Approximately one 5m² pack of Wickes fleece and two 5m packs of jointing tape should be sufficient to cover a 5m² room. Ensure you have enough Wickes External and Internal Corners to complete your room.

Timber Floor Installation

1



Determine where your wetroom floor is to be installed and remove the original floor covering to expose the floorboards. Lay the Wickes Deck flat on the floorboards and mark around it with a pencil.

2



Remove the Wickes Deck and cut along the lines with a circular saw to the depth of the floor boards. Beware of any pipe work or electric cables that may be concealed under the floor.

3



The floor boards can now be removed to accommodate the Wickes Deck.

4



The Wickes deck should always be fitted perfectly level on all four sides. Check the top of the joist are level. Adjust if necessary. The performance of the deck is determined by this accuracy.

5



It is important to secure the Wickes deck on all four sides with noggins to limit the amount of movement in the floor. They will also act as fixing points later on in the installation.

6



To install the Wickes Deck correctly, the height and location of the waste pipe and gully need to align with the 160mm aperture in the Wickes Deck. Mark the location on the joists.

7



Drill the noggin and push the waste pipe through to align with the hole in the aperture.



Do not drill the floor joists as this will compromise the structure of your house.

8



Place the waste in position and if required attach the gully making use of the 50mm to 40mm reducer.

Do not secure the gully with solvent weld at this time.

First, make sure it is in the correct location.

9



Lay the deck back on the joists and ensure the gully and deck aperture align.

Remove the deck and store for later.



10

Coat the reducer with solvent cement glue to create a good seal and join to the waste pipe.

Repeat process to join the reducer to the gulley.



11

The Wickes Deck needs to be supported between the joists to provide a solid platform and reduce movement in the floor. This is achieved by placing battens 18mm from the top and between each of the joists in readiness for a 18mm plywood base.



12

Cut and lay the plywood base ensuring a 160mm hole in the central section of the plywood base to allow access for the gulley.



13

The plywood base must be fixed securely to the battens.



14

Ensure the area is now level.

! It is imperative that the deck is perfectly level to ensure the pre-formed gradient on the Wickes Deck works effectively.



15

Replace the Wickes Deck and ensure the trap aligns with the gulley.

If the gulley is slightly off centre, gently adjust the gulley to align making use of the ball joint on the horizontal outlet.

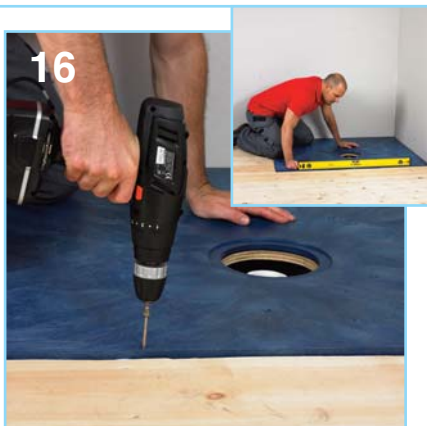

16

Check that the Wickes Deck is level and fix the Wickes Deck in place with the screws provided, starting from the outer edges and working in.

A final check should be made to see if the Wickes Deck is level on all four sides.

Remember the deck will not perform properly if this is not correct.



17

Remove the dip tube, fleece clamping ring and using the tool provided, unscrew the 1 1/2" threaded waste fitting from the gulley and keep in a safe place until they are required later in the installation .

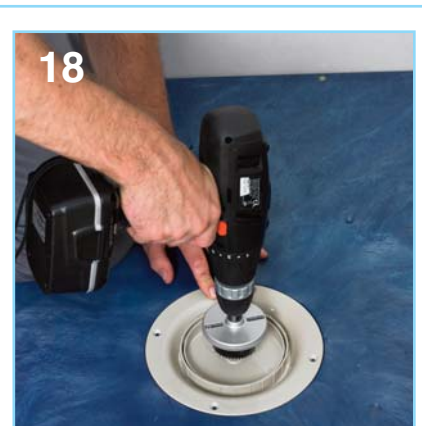

18

Place the undrilled gulley into position.

Check that the centre of the gulley base is in the centre of the gulley outlet.

Drill a 50mm hole in the plate with a hole saw to align with the gulley. This can be offset from the centre if required.



19

The Gully now needs to be sealed to the gully base.

Place the threaded waste fitting into the newly drilled base plate and catch the thread on the gully base.



20

Using the tool provided, tightening the gully base to the base plate.

Leave the tool in place to stop any debris falling into the gully.



21

Drill pilot holes through the gully base plate into the deck.



22

Secure the gully base with the four screws provided.

The gradient has now been installed and should be ready for the floor to be overboarded.



23

The Wickes Deck is now sitting higher than your bathroom floorboards. Using a suitable substrate, overboard the remaining bathroom to the height of the Wickes Deck.

Ensure at minimum the overboard is flat, however, we recommend a small gradient is created towards the Wickes Deck. This will ensure that any water escaping from the Deck area will flow back towards the waste.

Now you are ready to waterproof the room.



24

Measure the area to be waterproofed and cut the matting to size using a utility knife.

We recommend that you use manageable sizes of waterproof fleece at any one time, do not use straight from the roll as this could be difficult to manage.



25

Using Wickes PVA primer, coat any absorbent surfaces and allow to dry.



26

Using a 6mm square notched trowel, apply a flexible cement based tile adhesive to the first section of floor.

Ensure 100% even coverage of the tile adhesive and that the gradient of the Deck is maintained. The notched trowel will assist in maintaining the gradient.



Starting over the Wickes deck area, Lay the pre-cut fleece on the prepared floor and press down evenly over the entire area with the smooth edge of the trowel.

It is important that the fleece is bonded over the entire area without bubbles and ripples.

Note: The fleece will appear darker when properly bonded.

* **Tip:** When working in the area of the deck, it is important that you maintain the gradient of the deck when laying the fleece. If the gradient is removed the water will not flow towards the waste.



Once the Deck section has been fleeced, you must now cut out a round hole for the gully. Ensure the fleece is not cut past the inner ring of the gully to avoid leaking.



Apply a small amount of solvent cement to the inner face of the clamping ring and set into position securing the fleece to the waste.



Lay the rest of the fleece avoiding overlap or gaps at the joints. Ensure the fleece joins together perfectly. The joining tape applied later will cover the join in the fleece.



When joining two or more pieces of matting, apply flexible tile adhesive evenly across the joint and apply joining tape over the seam pressing firmly to ensure a complete bond to the adhesive.



Apply flexible tile adhesive along the edge of the wall and the fleece.

Fold the joining tape to and apply to the wall and floor create a watertight seal.

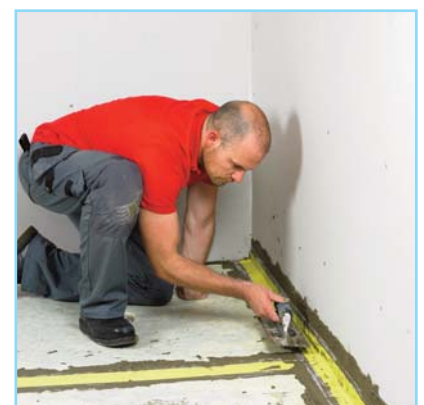

33



Apply a thin layer of tile adhesive on top of the joining tape in the corners of the bathroom and press the pre-formed corners into place ensuring they are fully bonded. This will offer a secure waterproof area.

34

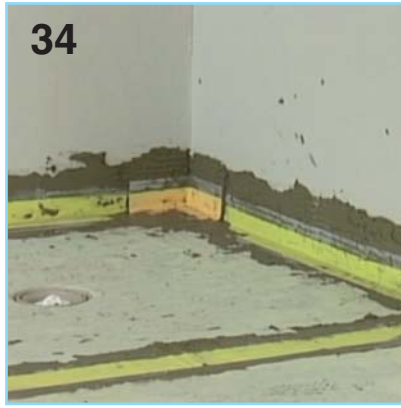

Once the floor is fully tanked, you are ready to install under floor heating.

The Wickes Under Floor Warming Mat System is easy to install and use but, as with any system, it is very important you do not damage the waterproof fleece when laying.

Please follow the manufacturer's instructions.

35



You are now ready to finalize your tiled gully height .

Replace the dip tube into the gully.

36



Place the height adjustment ring in the locating position on the gully base plate. The ring will then rotate anticlockwise on a rise and fall cam to locate the desired height .

37

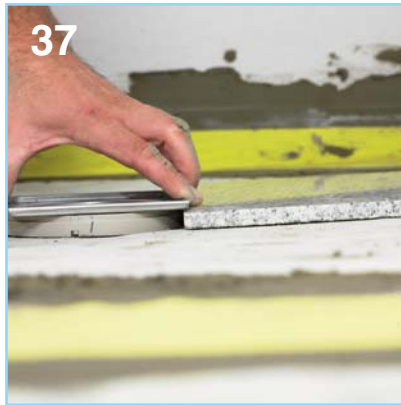

The lip of the stainless steel frame should sit flush with the tile to allow the maximum flow rate. Remember to allow for under floor heating and an extra layer of tile adhesive. Mark the height position on the cam then remove the ring.

! At this stage the grate will not line up with the direction of the tile. This can be altered once the cam has been fully secured in position.

38



Apply a small amount of solvent cement onto the cam faces of the ring and return to the marked position and allow solvent to dry.

Once the solvent is dry, the grate should move independently of the ring to allow you to align the grate with your tiling pattern.

39



You are now ready to tile your wetroom.

! For the less experienced tiler, using smaller tiles or mosaics will make it easier to maintain the gradient of the Deck.

! **IMPORTANT:** Some tiles can become very slippery when wet, so make your choice with care.

40

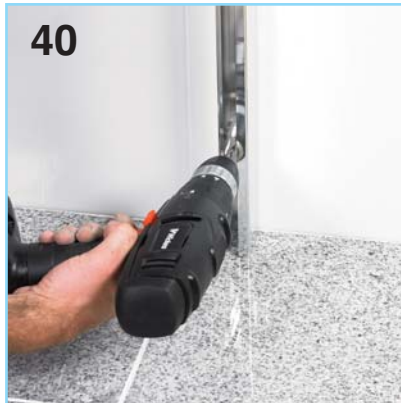

You now have a beautiful wet room that can either be fitted with a screen, enclosure or left as an open shower area.

! When installing the Wickes Deflector Panel, ensure the wetroom installation has had 12 hours to set before drilling the floor support to the tiles.

41



The Wickes deflector panel will require a 4mm deep hole drilled in the tile, to secure the base plate, and as such, we recommend the use of tiles no less than 6mm in thickness.

! **IMPORTANT:** Never drill completely through the tile as this could damage the fleece and compromise your wetroom floor.



Completed Wetroom Deck & Deflector Panel

Concrete Floor Installation

BEFORE STARTING A CONCRETE INSTALLATION

Breaking up structural floors is not permitted as it will weaken the structural integrity of the floor slab.

We recommend you fit the Wickes Deck on a raised substrate.

Be careful never to compromise the Damp Proof Course.

Seek professional advice before attempting a concrete floor installation.

CONCRETE SCREED →

CONCRETE

SHOWER TRAP

1

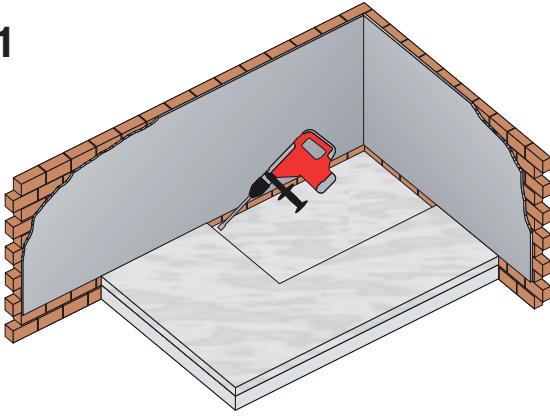

If using a screed floor:

Place the deck in the desired location and mark around.

Excavate all concrete within the marked area to a depth of 30mm ensuring you do not compromise the structure of the floor slab.

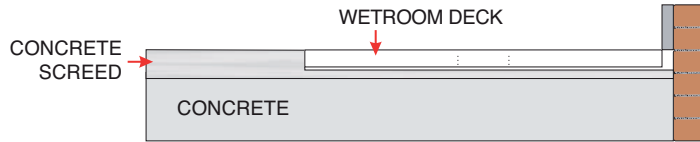

2

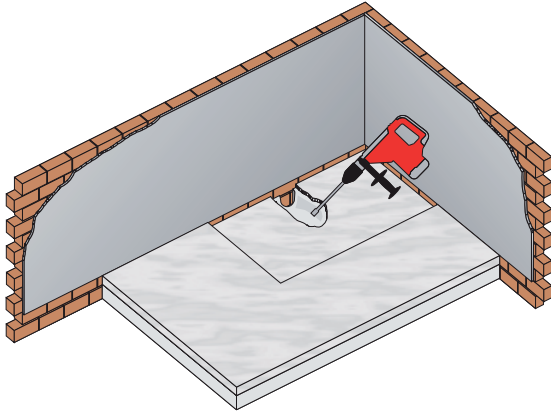

Remove enough concrete for the installation of the waste pipe and gully trap.

You will need to ensure that when the waste pipe and trap are installed the trap is located directly below the centre hole of the Deck.

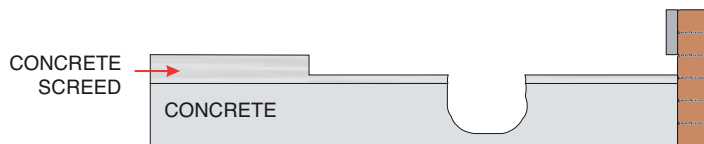

3

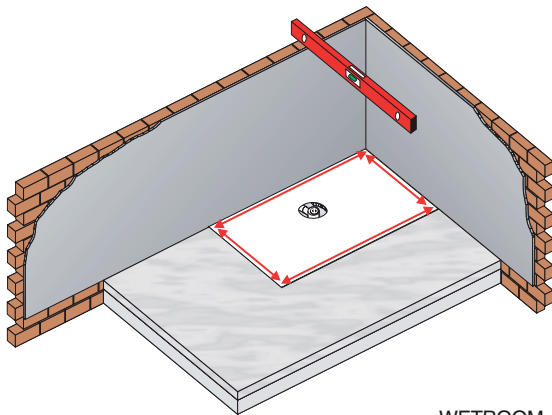

Once the waste has been solvent welded into place, lay the deck in position and ensure it is level on all four sides, flush with the rest of the floor and the gully is in the centre of the aperture.

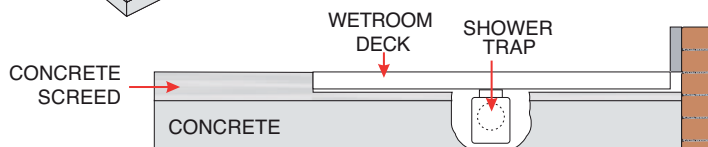

4

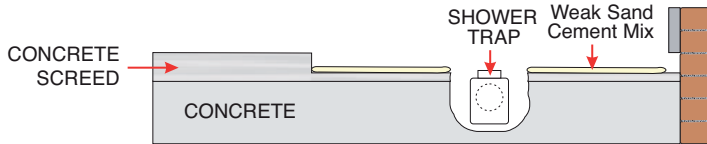
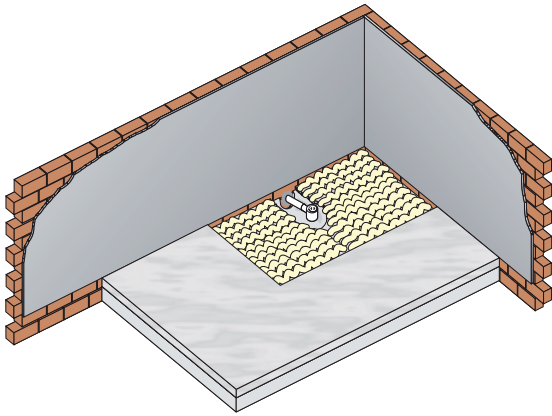

Bed the Wickes deck down on a weak sand and cement mix.

Make sure the deck is level on all four sides and pack accordingly.

Leave to set for 12 hours.

5

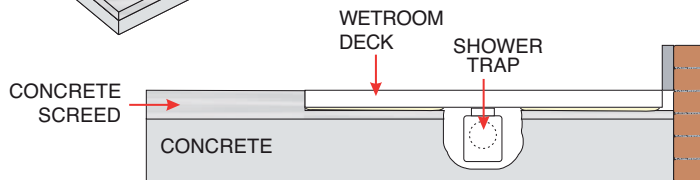
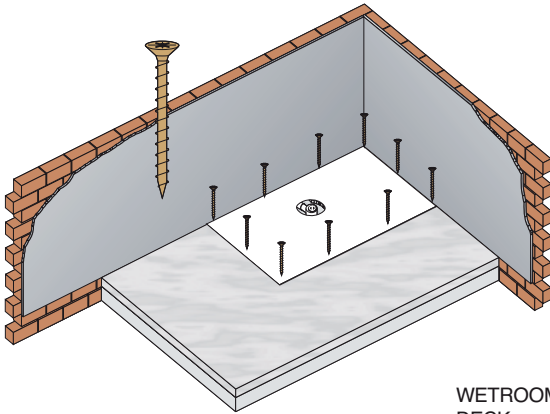

Now that the Wickes Deck is in position secure it with the screws provided along with suitable raw plugs.

It is only necessary to screw down the deck along the outer edges as shown.

6

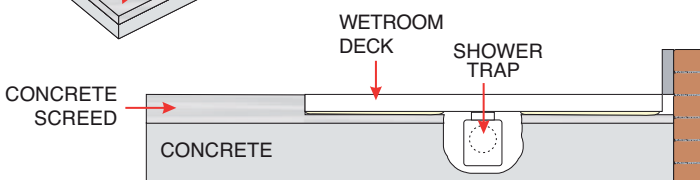
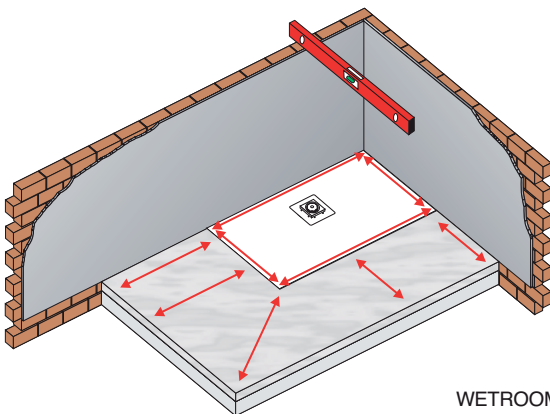

Finally check that the Wickes Deck is level on all four sides.

! IMPORTANT: The rest of the floor must also be level

Your deck is now installed and you are ready finalise the installation of the Wickes waste.

Please follow the main instruction steps 17-42 for installing the wetroom waste and tanking kits.

TILING TEMPLATE DIMENSIONS

Refer to dimensions when plotting tile template

